

AL Series

Tropical Lighting System



Installation Manual

Important Notes and Warnings

This installation and instruction manual provides installation instructions for the Sol Tropical Lighting System (AL) Series solar LED lighting systems. The entire contents of this manual should be thoroughly reviewed and understood prior to installing this equipment. Do not discard this manual, as it contains complete installation instructions.

To insure proper operation of this equipment, it is important that the equipment be utilized for its intended use. Any use of this equipment for purposes other than those intended will void all warranties.



Installation and/or troubleshooting should be performed only by qualified personnel. Follow local codes at all times during installation of the Sol AL Series.



Be very careful when working with batteries.



Do not allow bare ends of the wires to touch each other or grounded metal parts while connected to the controller. This will damage the controller.

Parts Provided

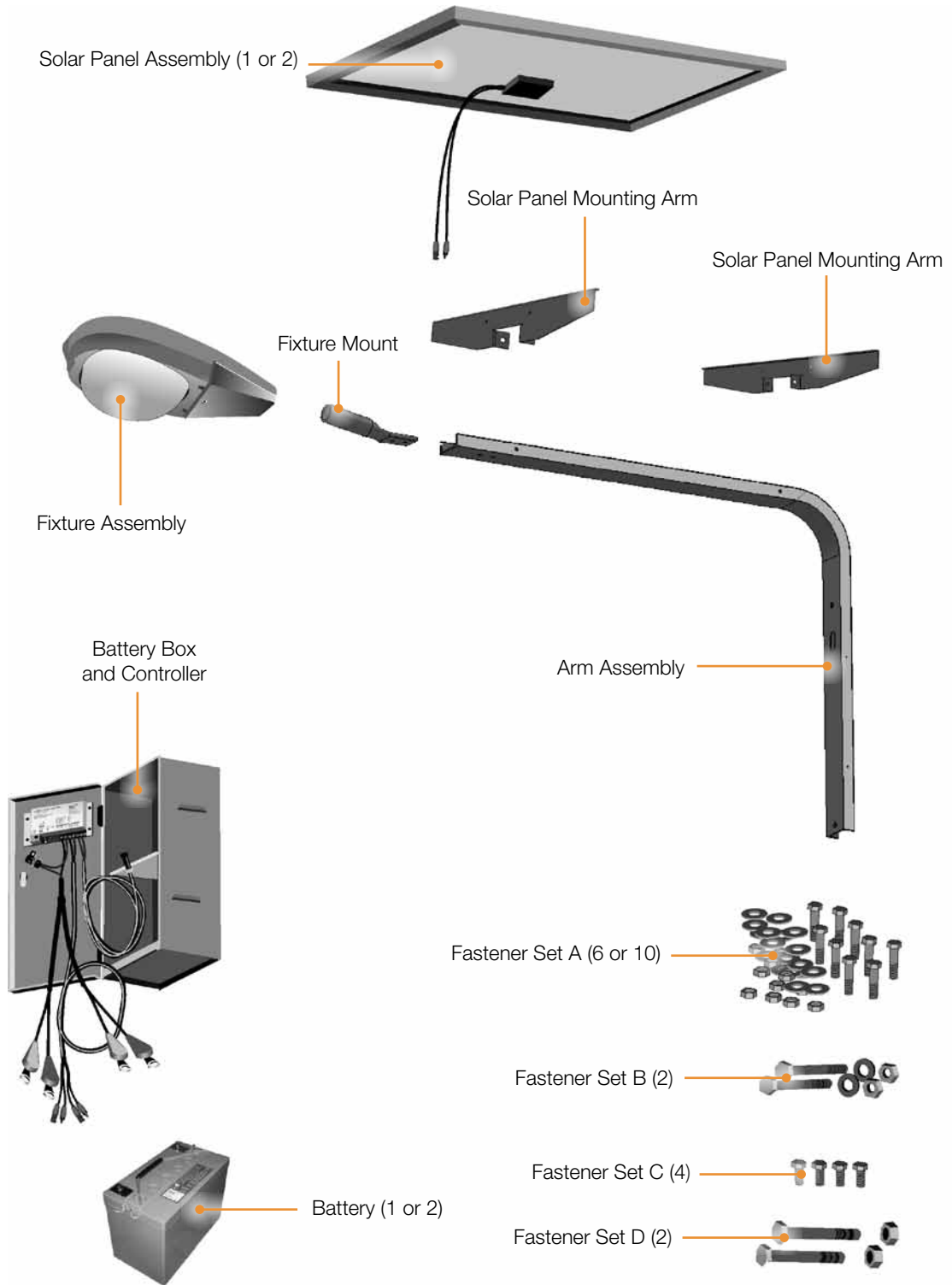

1.0 Locating

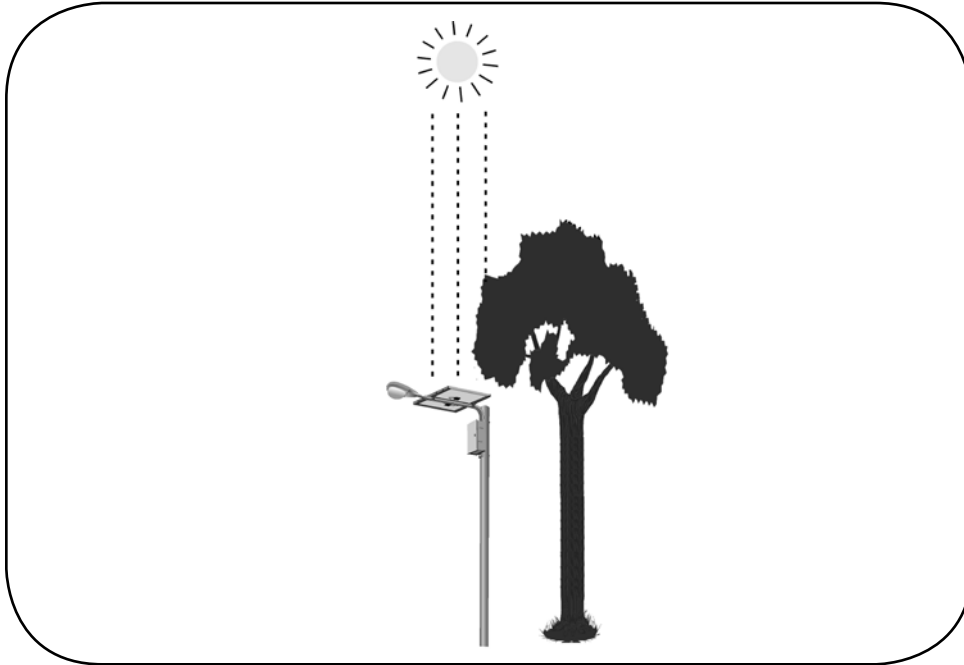
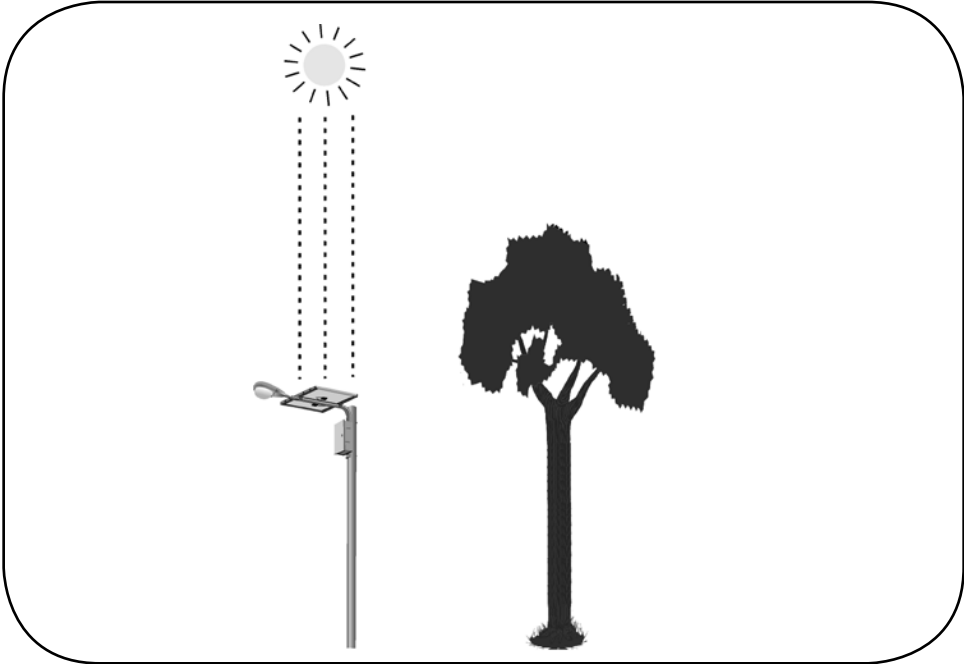

2.0 Assembly

2.1 Secure the Fixture Bracket to the Arm

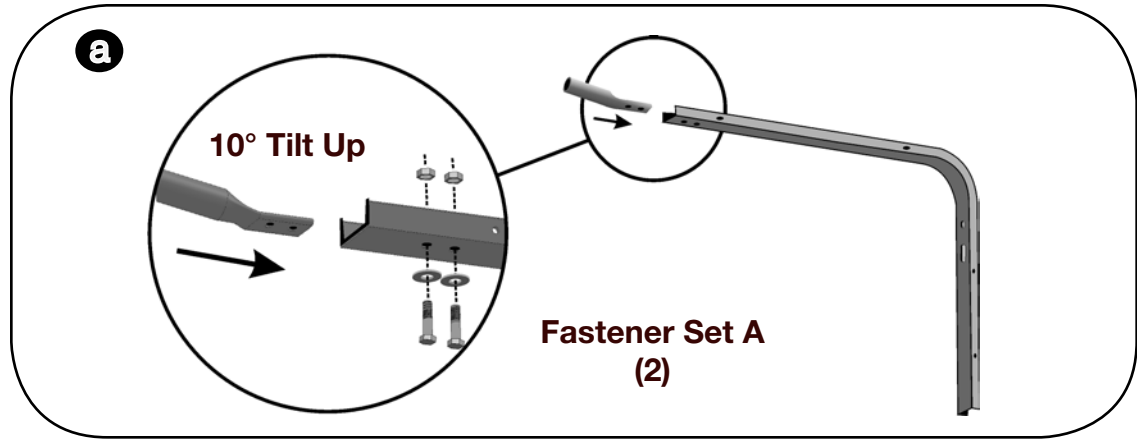

2.2 Secure the Battery Box to the Arm

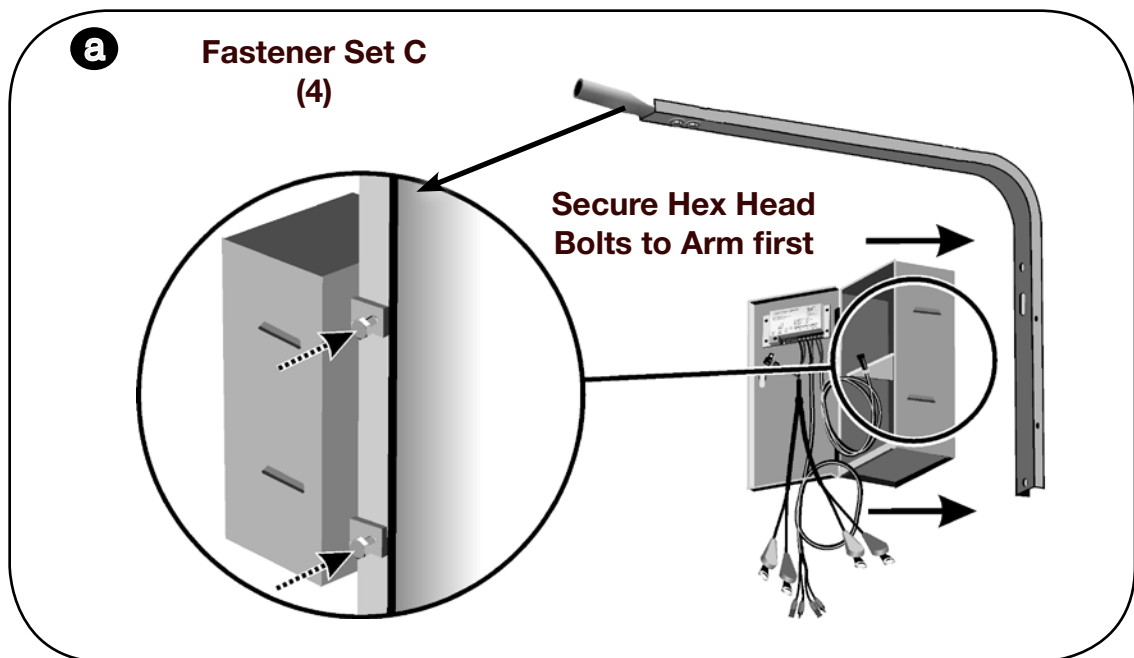

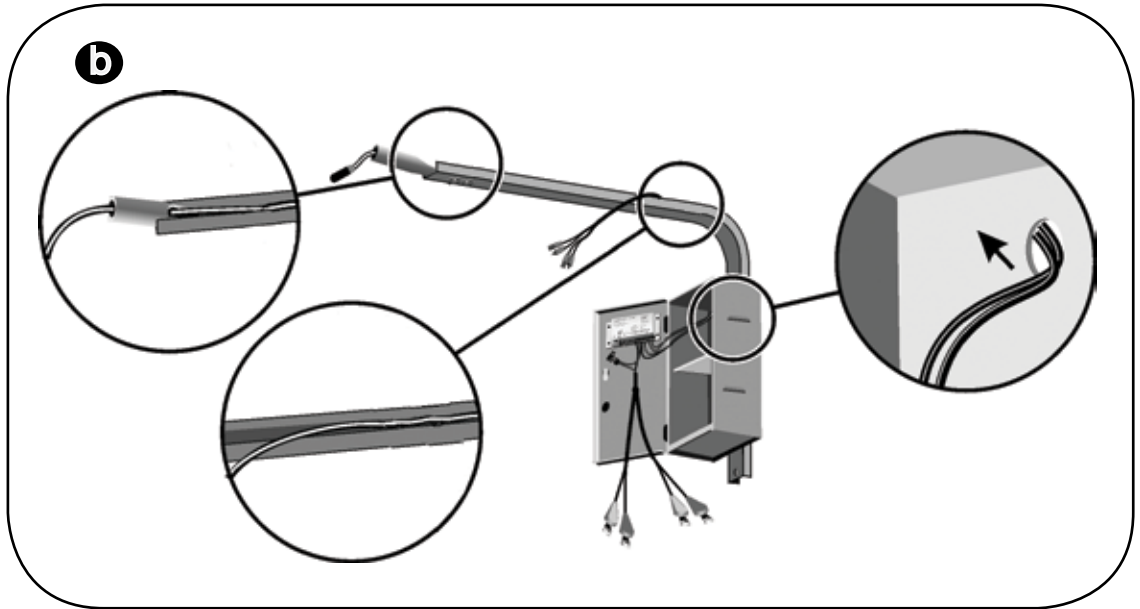

2.4 Secure Solar Panel(s) to Bracket and Attach

One Solar Panel:

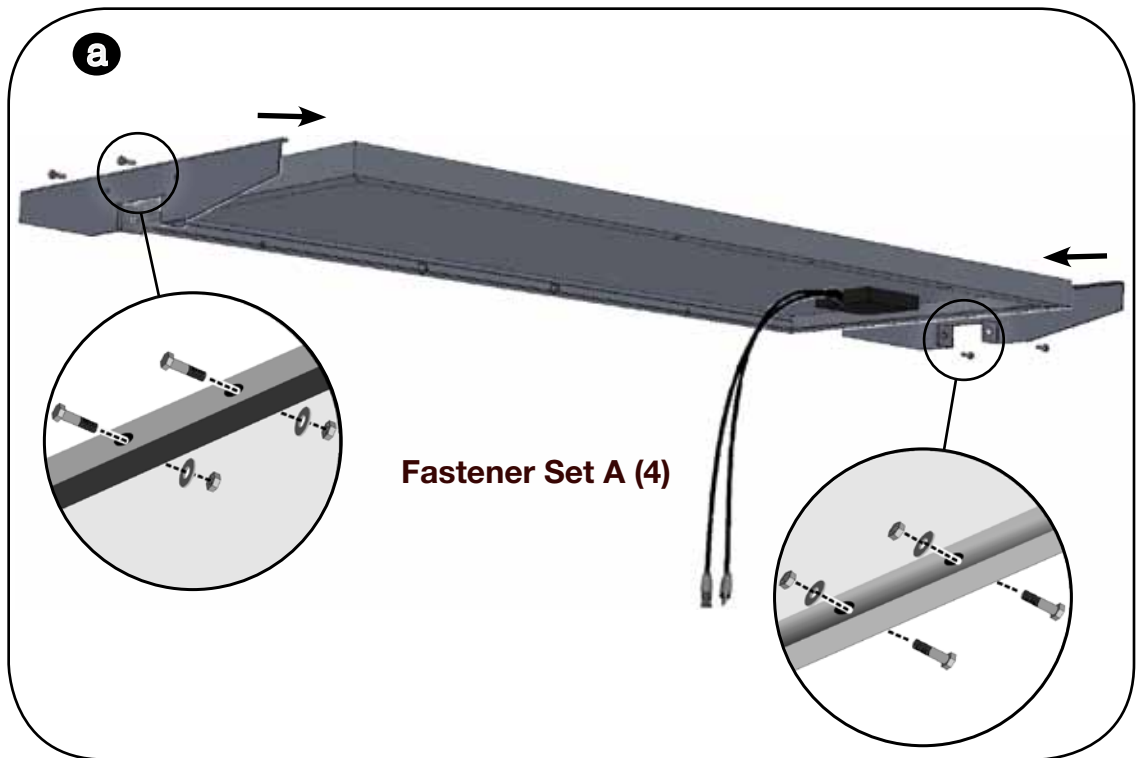

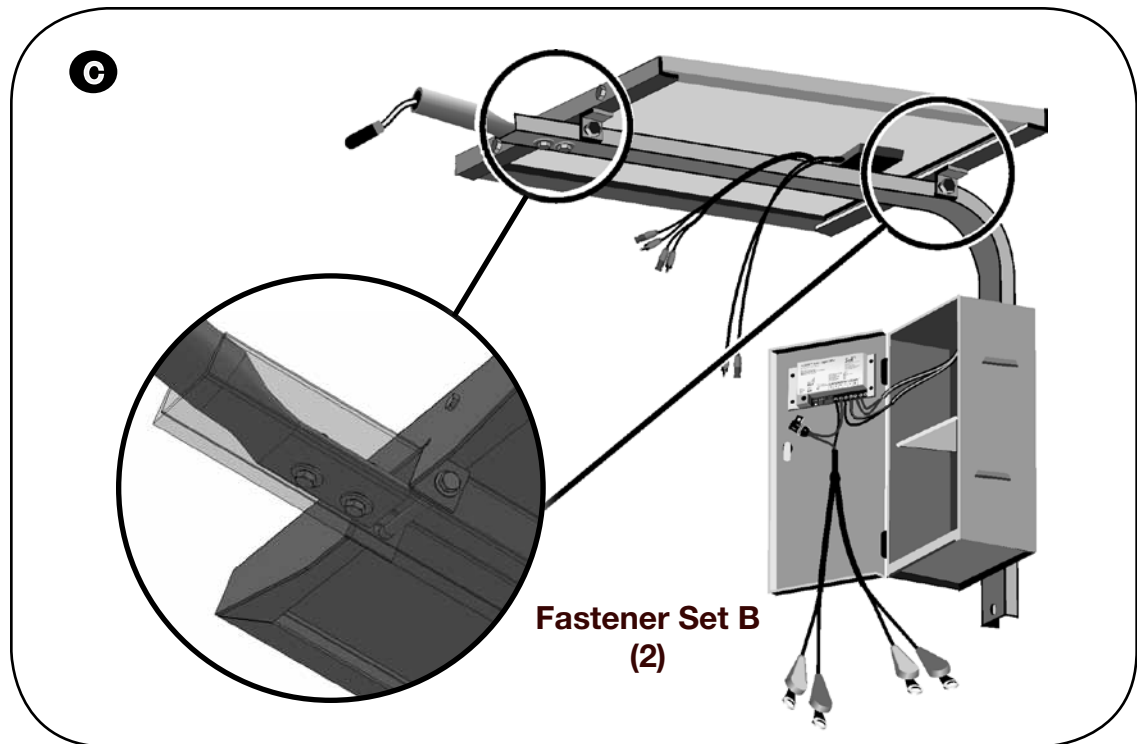
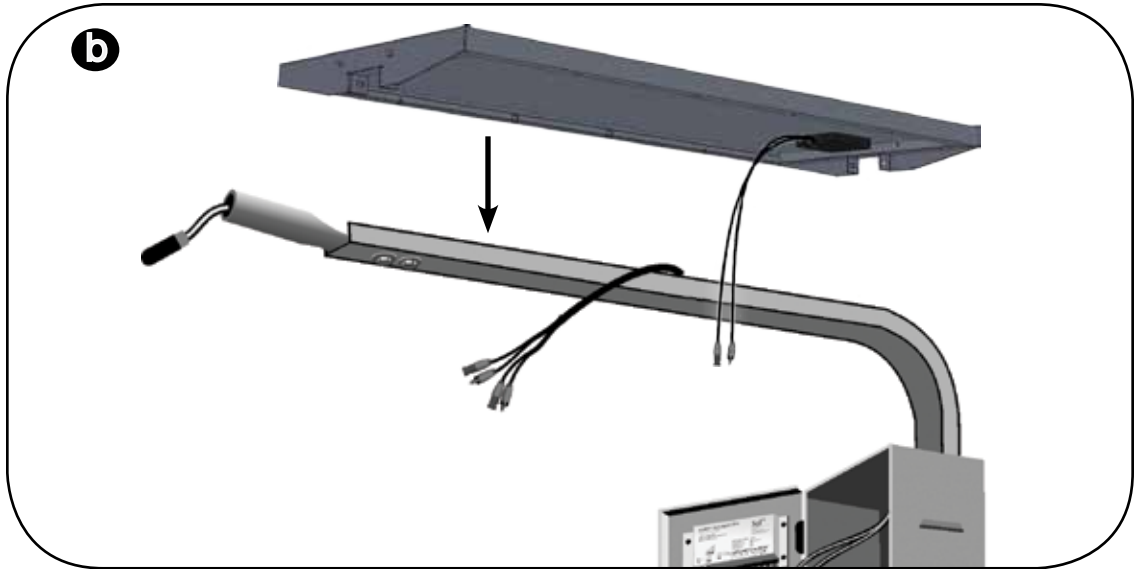

Two Solar Panels:

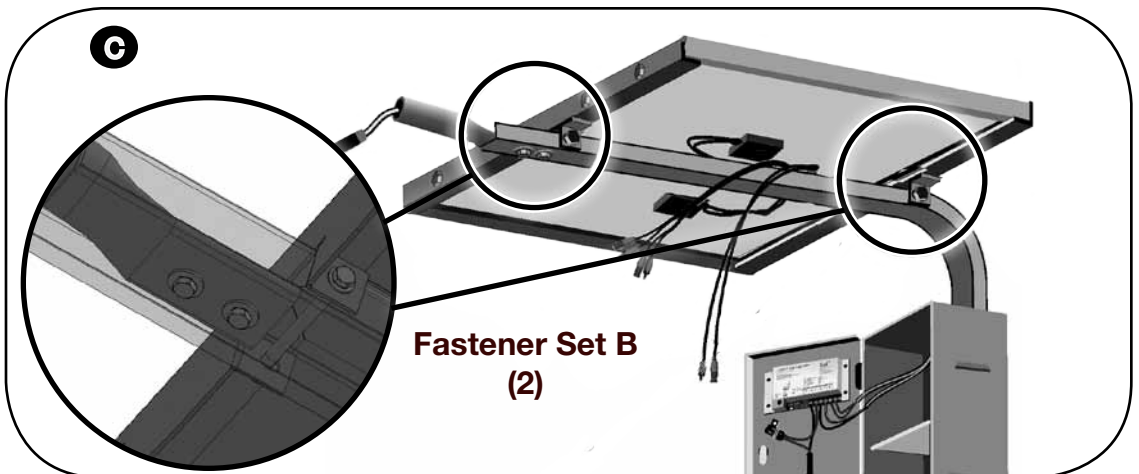
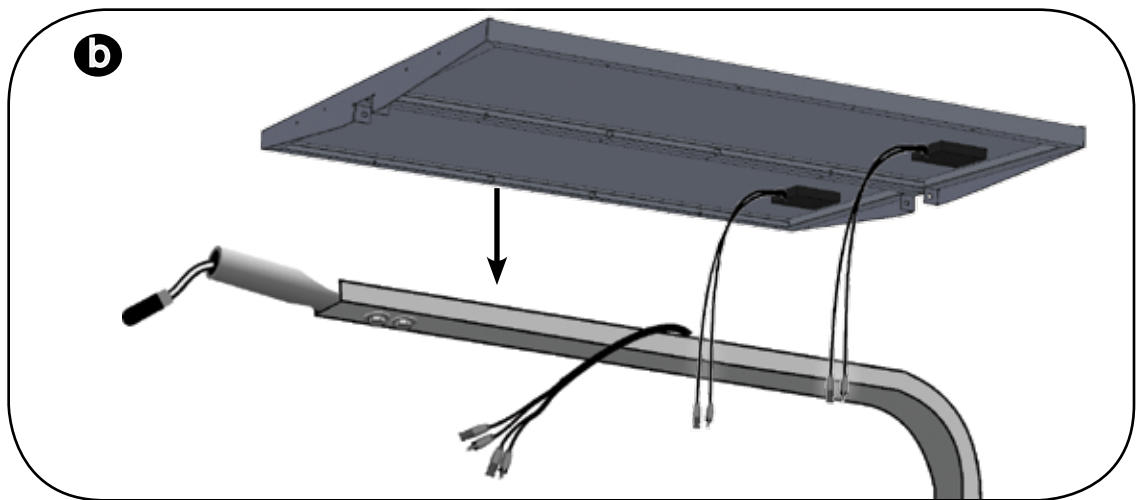
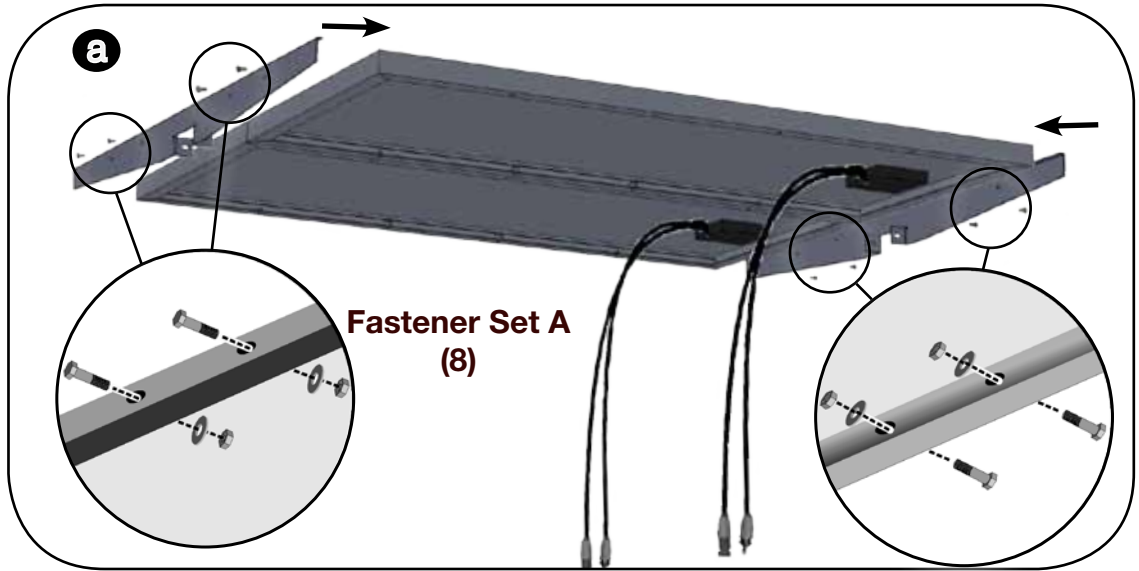

2.5 Connect the Solar Panel Cable(s)

One Solar Panel:

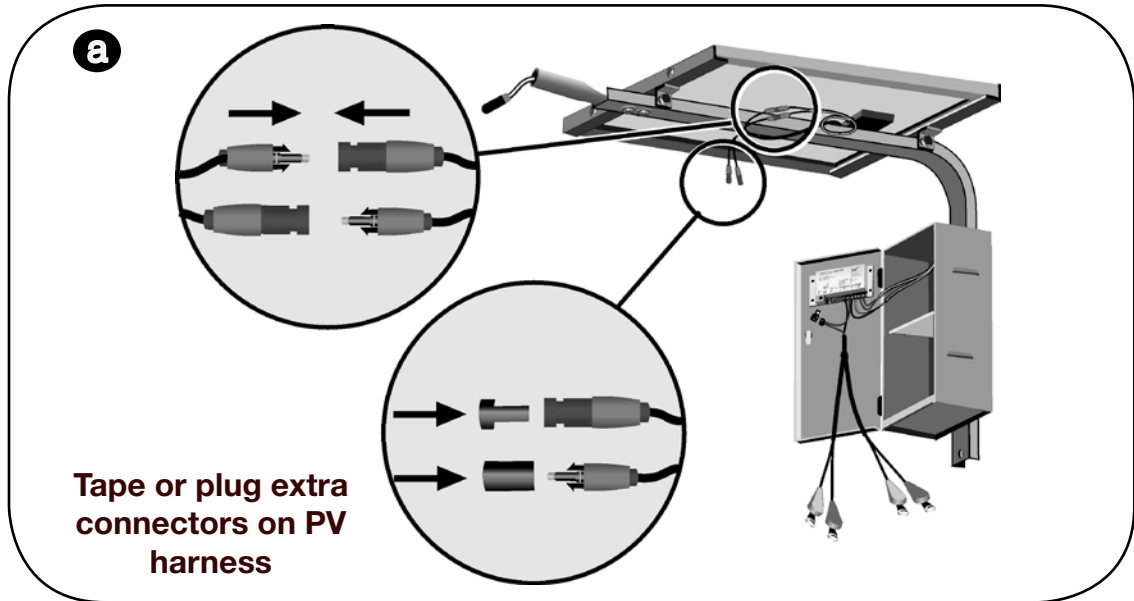

Two Solar Panels:

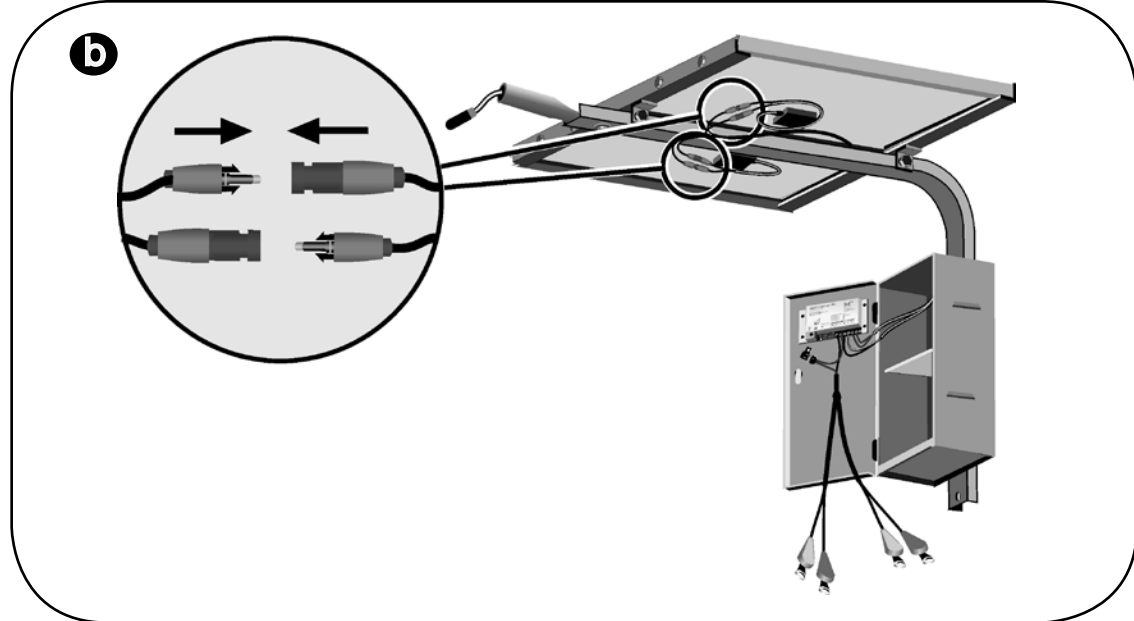

2.6 Secure the Light to the Arm

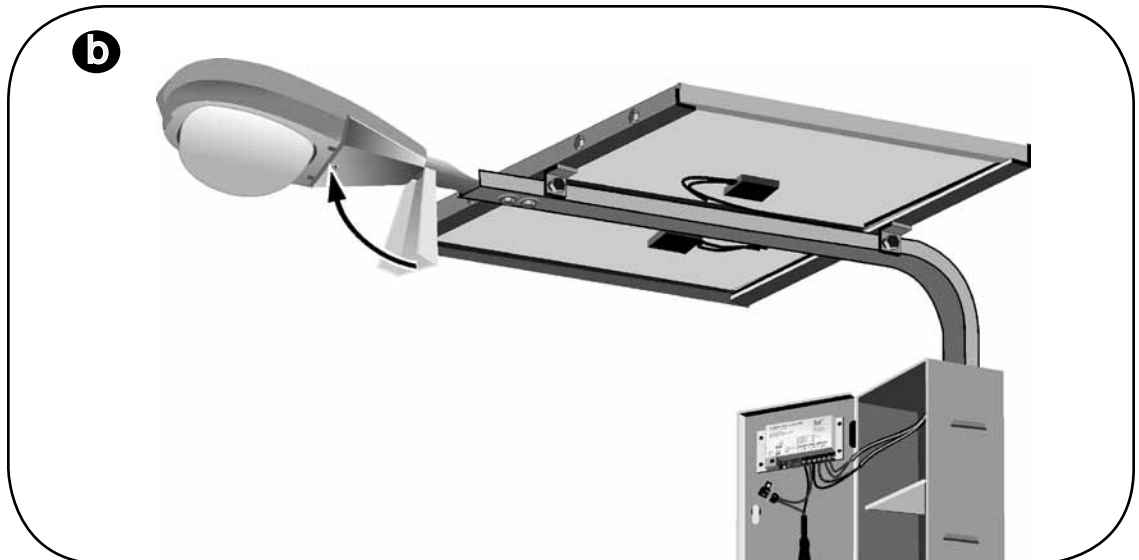
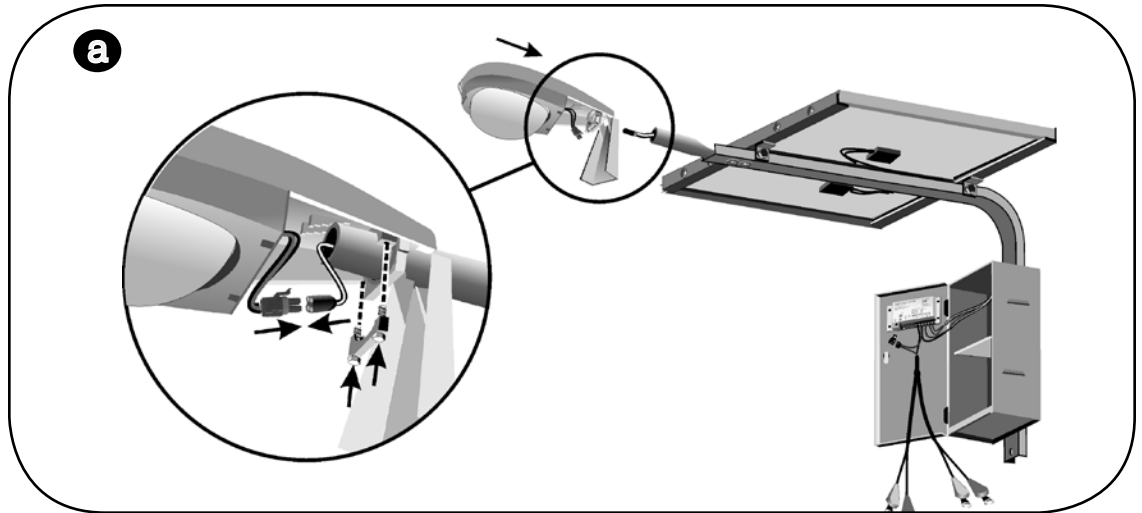

2.7 Attach the Assembled Arm to the Pole

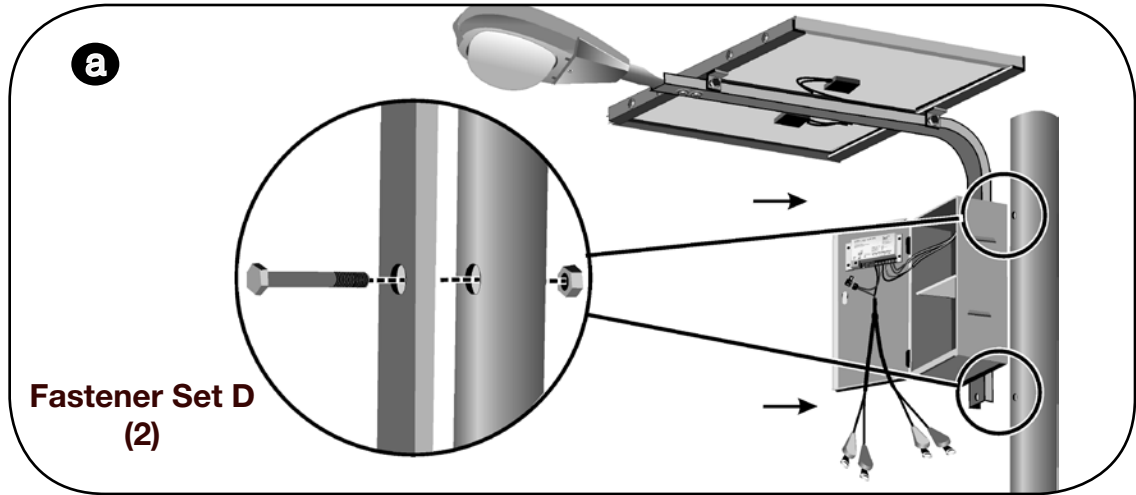

On the Ground:

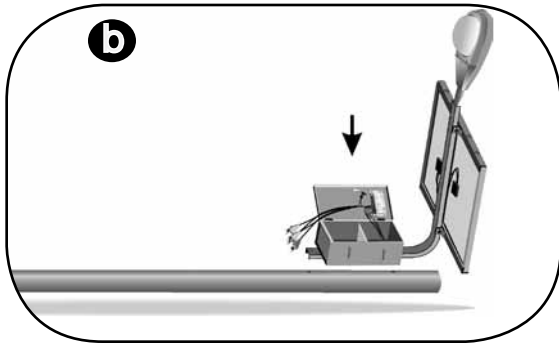

On the Pole:

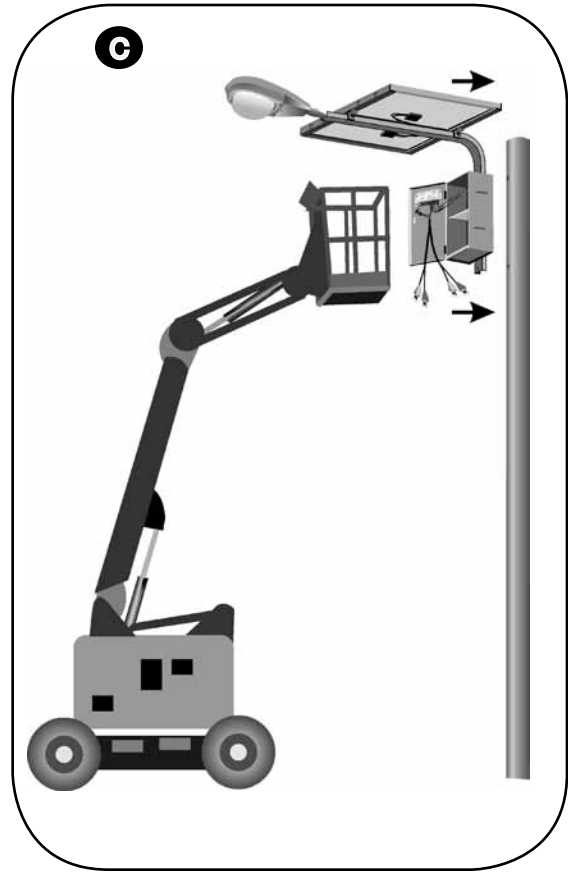

2.8 Remove the Fuse

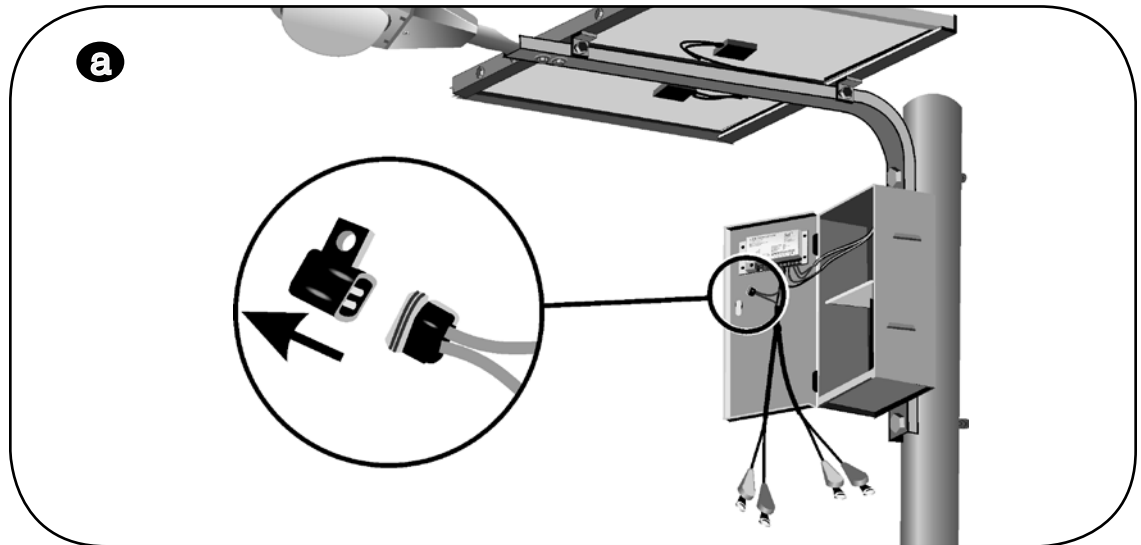

2.9 Connect and Insert the Battery (or Batteries)

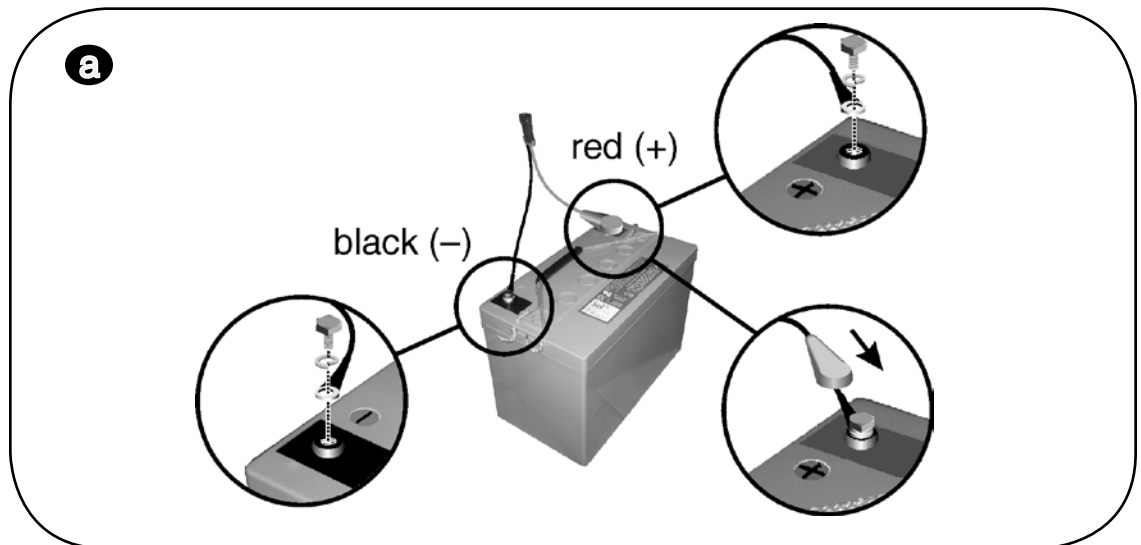

One Battery:

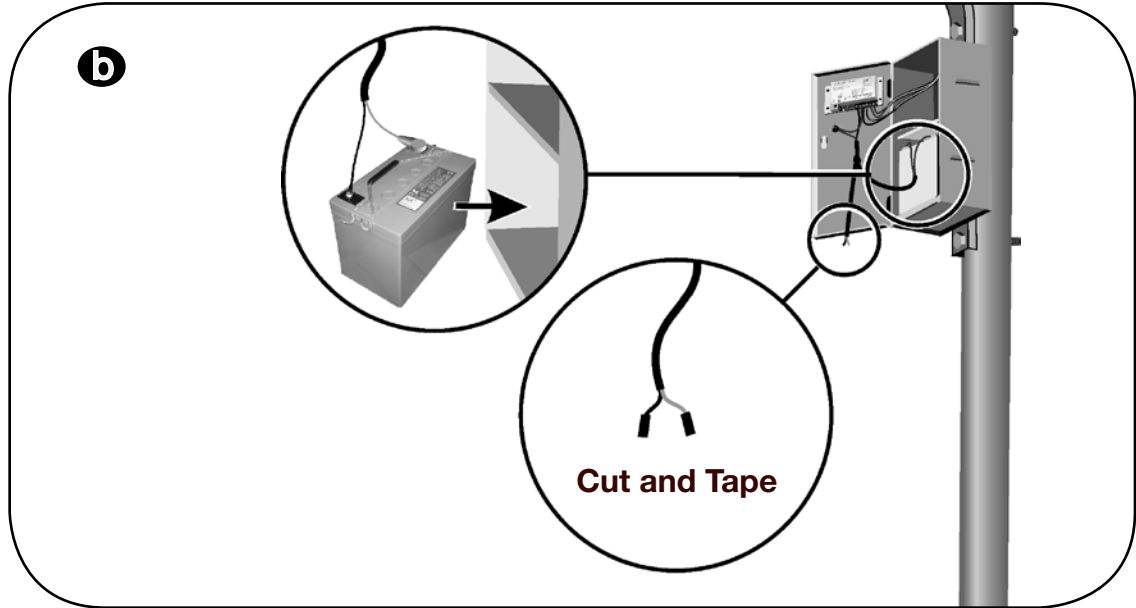

Two Batteries:

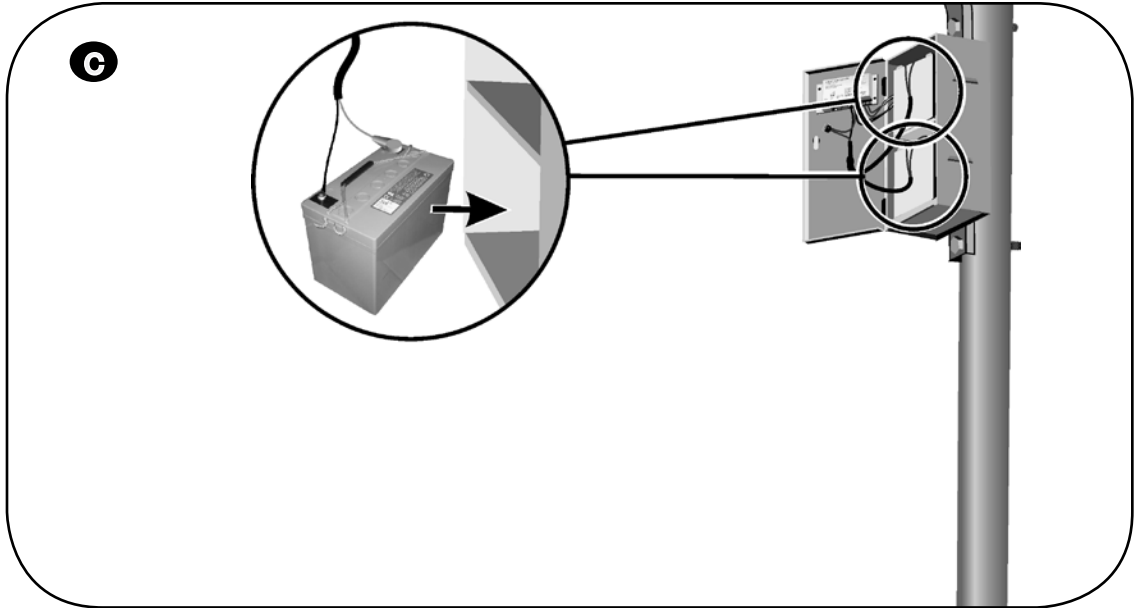

2.10 Insert the Fuse, Test, and Close

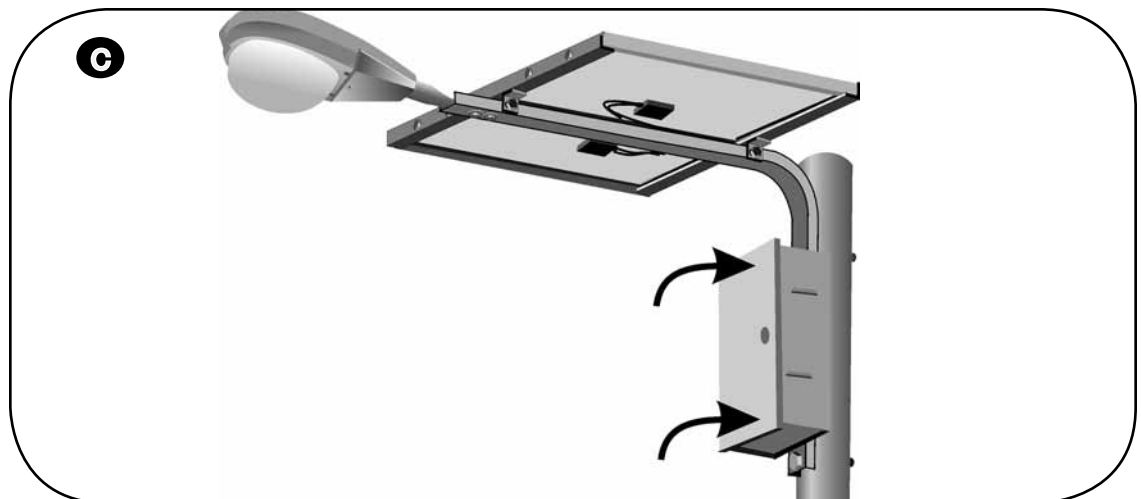
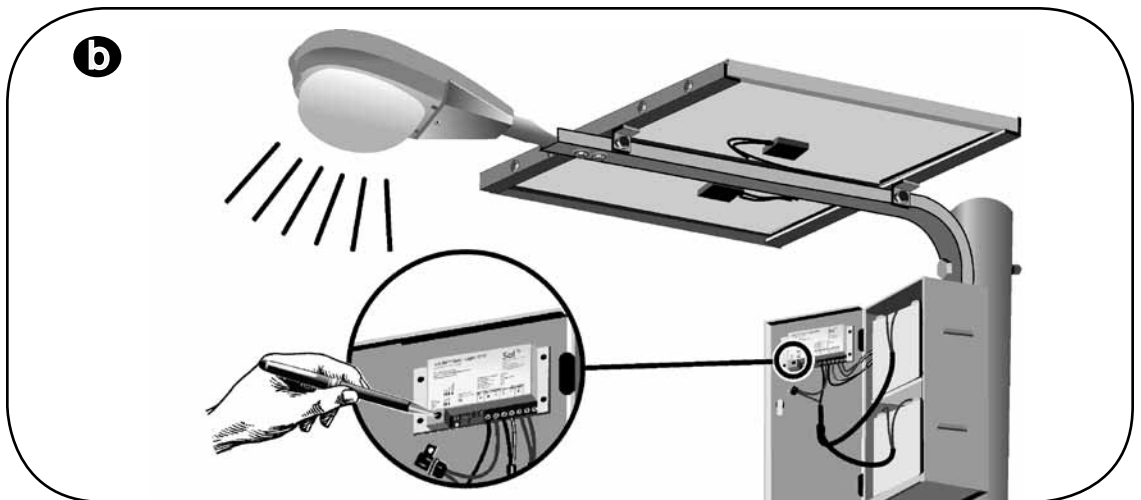
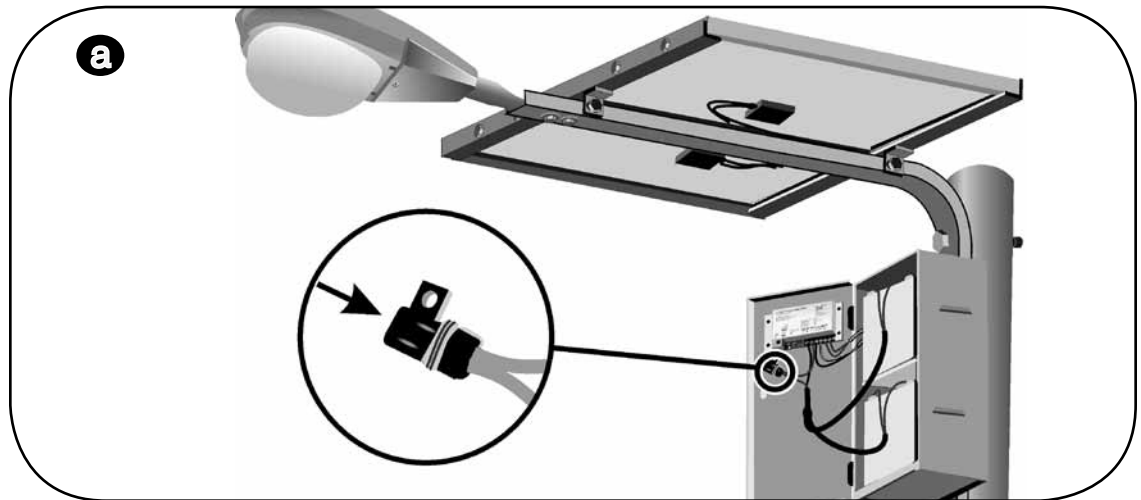

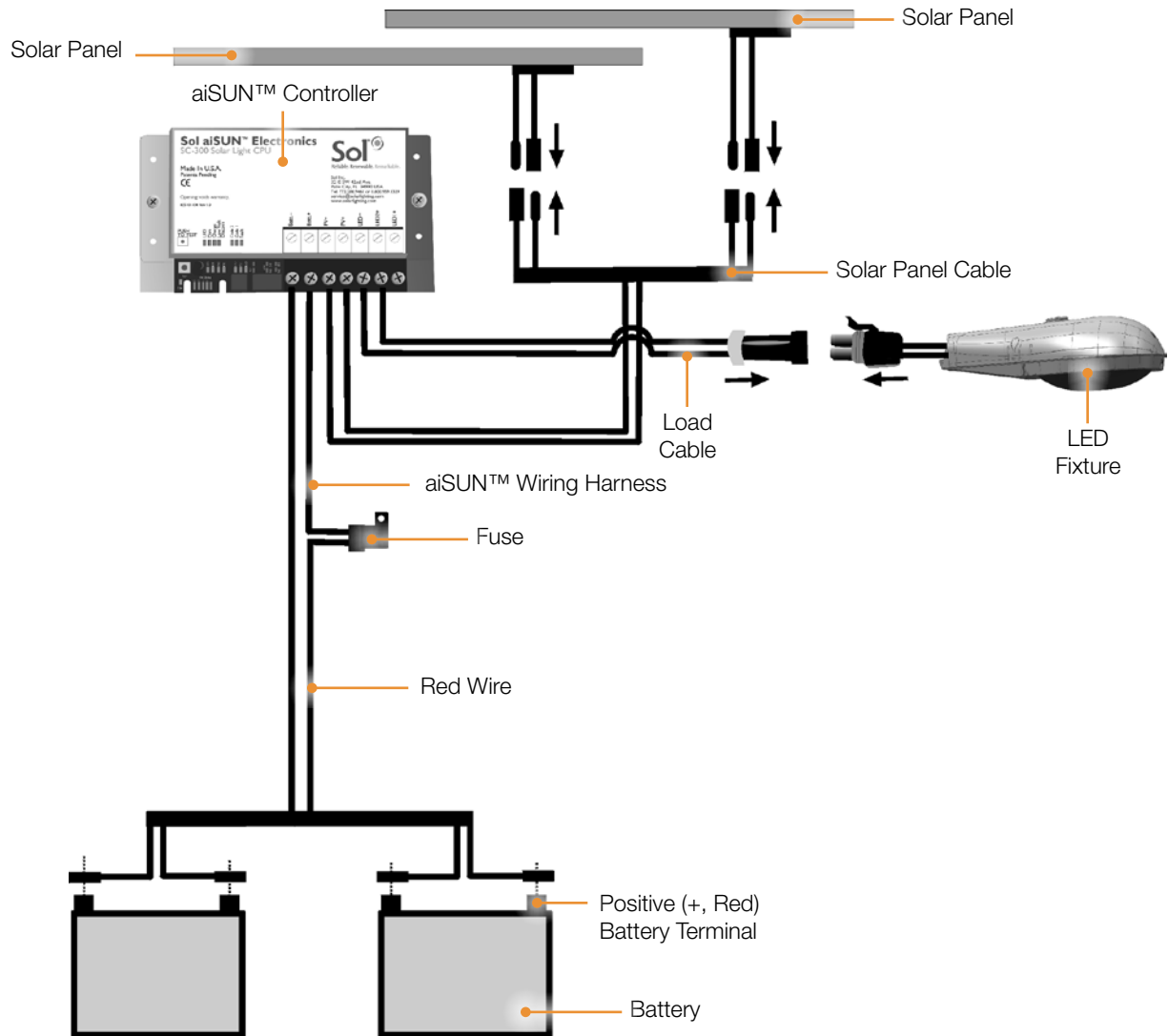

In-Warranty Service Instructions

A Returned Merchandise Authorization (RMA) number must be obtained from SOL Inc. before equipment can be returned for repair or replacement under warranty.

We require the following information before we can issue an RMA number:

- Controller Number for the product being returned
- Serial Number of the product being returned
- Work Order Number (located inside the battery box)
- A description of the problem
- The address to which the repaired or replaced product is to be shipped

Equipment being returned must be properly packaged to protect it from damage during shipment. Shipping costs and insurance to SOL Inc. are the responsibility of customer.

Upon verification of failure due to defects in materials or workmanship, we will either repair or replace the product at our discretion. The customer will be responsible for all shipping and handling charges for any equipment that is sent to SOL Inc. in error (no definable problems).



Reliable. Renewable. Remarkable.

Sol Inc. | 3210 SW 42nd Avenue | Palm City, Florida 34990

www.solarlighting.com

E-mail support: support@solarlighting.com

Phone: +1.772.286.9461 | Toll: 800.959.1329 (USA & Canada)

Fax: +1.772.286.9616

Office Hours: Monday - Friday: 8:30 am to 5:00 pm (EST)

© 2011 Sol Inc. All rights reserved